

**UNIVERSITY OF LATVIA**

Erasmus code	<b>LV RIGA01</b>
PIC	999871830
Address	Raina Blvd. 19, Riga, LV-1586, Latvia
Website	<a href="https://www.lu.lv/en/">https://www.lu.lv/en/</a>
<b>Rector</b>	<b>Acting rector Professor Guido Straube</b>

**INTERNATIONAL RELATIONS**

Address	Raina Blvd. 19, Riga, LV-1586, Latvia
Website	<a href="https://www.lu.lv/en/admission/for-international-students/exchange/contacts/">https://www.lu.lv/en/admission/for-international-students/exchange/contacts/</a>
<b>Erasmus Institutional Coordinator</b>	<b>Mrs. Aline GRZIBOVSKA</b>
Phone	+371 6703 3997
Fax	+371 6722 5039
E-mail	<a href="mailto:ad@lu.lv">ad@lu.lv</a>
<b>Head of Mobility Division</b>	<b>Ms. Sintija MACULEVICA</b>
Phone	+371 6703 3968
E-mail	<a href="mailto:sintija.maculevica@lu.lv">sintija.maculevica@lu.lv</a>
<b>Contact person for outgoing students</b>	<b>Ms. Marta VILKAUSA</b>
Phone	+371 6703 4406
E-mail	<a href="mailto:marta.vilkausa@lu.lv">marta.vilkausa@lu.lv</a>
<b>Contact person for incoming students</b>	<b>Ms. Beate RAMINA – LO BELLO</b>
Phone	+371 6703 4350
E-mail	<a href="mailto:beate.ramina@lu.lv">beate.ramina@lu.lv</a>
	<b>Ms. Sintija URTANE</b>
Phone	+371 6703 4336
E-mail	<a href="mailto:sintija.urtane@lu.lv">sintija.urtane@lu.lv</a>
<b>Contact person for IIA Erasmus+ agreements with Programme Countries</b>	<b>Ms. Beate RAMINA – LO BELLO</b>
Phone	+371 6703 4350
E-mail	<a href="mailto:beate.ramina@lu.lv">beate.ramina@lu.lv</a>
<b>Contact person for IIA Erasmus+ agreements with Partner Countries</b>	<b>Ms. Sintija URTANE</b>
Phone	+371 6703 4336
E-mail	<a href="mailto:sintija.urtane@lu.lv">sintija.urtane@lu.lv</a>

<b>INFORMATION FOR INTERNATIONAL STUDENTS</b>	
<b>Academic calendar 2020/2021</b>	
<b>Autumn semester</b>	
<i>registration week</i>	31.08.2020 - 06.09.2020
<i>studies</i>	07.09.2020 - 23.12.2020
<i>Christmas and New Year holidays</i>	24.12.2020 - 03.01.2021
<i>individual studies and exams</i>	04.01.2021 - 29.01.2021
<b>Spring semester</b>	
<i>registration week</i>	02.02.2021 - 07.02.2021
<i>studies</i>	08.02.2021 - 28.03.2021
<i>Easter holidays</i>	29.03.2021 - 05.04.2021
<i>studies</i>	06.04.2021 – 06.06.2021
<i>individual studies and exams</i>	07.06.2021 - 04.07.2021
Website	<a href="https://www.lu.lv/en/studies/study-process/academic-calendar/">https://www.lu.lv/en/studies/study-process/academic-calendar/</a>
Application deadlines	Autumn Spring May 15 <sup>th</sup> November 15 <sup>th</sup>
Nomination deadlines (by e-mail <a href="mailto:exchange@lu.lv">exchange@lu.lv</a> )	Autumn Spring April 15 <sup>th</sup> October 15 <sup>th</sup>
Language of instructions	The official language of instruction is Latvian. Courses for international students are offered in English.
Language requirements	<b><u>English B1</u></b>  Students applying for the following faculties have additional language requirements:  <b>Faculty of Humanities:</b> <u>Bachelor level programmes:</u> English philology: English B2; Modern Languages and Business Studies: English B2; French philology: French, Italian or Spanish B1; German philology: German B1; Russian philology: Russian B1; <u>Master level programmes:</u> English philology: English B2; Romance studies: French, Italian or Spanish B2 German philology: German B2; Russian philology: Russian B2  <b>Faculty of Medicine:</b> Medicine and Dentistry programmes: B2
Application information for incoming students	<a href="https://www.lu.lv/en/admissions/exchange-studies/">https://www.lu.lv/en/admissions/exchange-studies/</a>
Accommodation information	<a href="https://www.lu.lv/en/studies/student-life/accommodation/">https://www.lu.lv/en/studies/student-life/accommodation/</a>

Courses for incoming students	<a href="https://www.lu.lv/en/admission/for-international-students/exchange/courses/">https://www.lu.lv/en/admission/for-international-students/exchange/courses/</a>
Immigration information	<a href="https://www.lu.lv/en/admission/for-international-students/exchange/visas/">https://www.lu.lv/en/admission/for-international-students/exchange/visas/</a>
General and Practical information for incoming students	<a href="https://www.lu.lv/en/admission/for-international-students/exchange/">https://www.lu.lv/en/admission/for-international-students/exchange/</a>
Credit points	1 Latvian credit point = 1.5 ECTS
Approx. expenses per month	
Accommodation	100 – 300 EUR
Food & drinks	300 EUR
Books	20 EUR
Local Transportation	30 EUR
<i>Total</i>	<i>450 – 650 EUR</i>

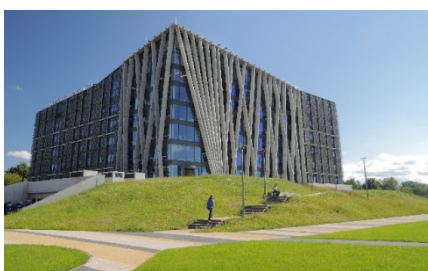

**INTERNATIONAL COORDINATORS AT FACULTIES**

<b>FACULTY OF BIOLOGY</b>	
Departmental Coordinator	<b>Assoc. prof. Liga OZOLINA-MOLLA</b>
E-mail	<a href="mailto:liga.ozolina-molla@lu.lv">liga.ozolina-molla@lu.lv</a>
<b>FACULTY OF CHEMISTRY</b>	
Departmental Coordinator	<b>Doc. Agnese OSITE</b>
E-mail	<a href="mailto:agnese.osite@lu.lv">agnese.osite@lu.lv</a>
<b>FACULTY OF COMPUTING</b>	
Departmental Coordinator	<b>Prof. Juris BORZOVS</b>
E-mail	<a href="mailto:juris.borzovs@lu.lv">juris.borzovs@lu.lv</a>
<b>FACULTY OF BUSINESS, MANAGEMENT AND ECONOMICS</b>	
Departmental Coordinator	<b>Ms. Zane SVILANE</b>
E-mail	<a href="mailto:zane.svilane@lu.lv">zane.svilane@lu.lv</a>
<b>FACULTY OF EDUCATION, PSYCHOLOGY AND ART</b>	
Departmental Coordinator	<b>Ms. Laura FOMINA</b>
E-mail	<a href="mailto:laura.fomina@lu.lv">laura.fomina@lu.lv</a>
<b>FACULTY OF GEOGRAPHY AND EARTH SCIENCES</b>	
Departmental Coordinator	<b>Prof. Zaiga KRISJANE</b>
E-mail	<a href="mailto:zaiga.krisjane@lu.lv">zaiga.krisjane@lu.lv</a>
<b>FACULTY OF HISTORY AND PHILOSOPHY</b>	
Departmental coordinator for Department of <b>History and Archaeology, Philosophy and Ethics</b>	<b>Dr. Artis SVECE</b>
E-mail	<a href="mailto:artis.svece@lu.lv">artis.svece@lu.lv</a>

**INTERNATIONAL COORDINATORS AT FACULTIES**

<b>FACULTY OF HUMANITIES</b>	
Departmental Coordinator	<b>Ms. Anastasija VEDELA</b>
E-mail	<a href="mailto:anastasija.vedela@lu.lv">anastasija.vedela@lu.lv</a>
<b>FACULTY OF LAW</b>	
Departmental Coordinator	<b>Ms. Daina ANDREJEVA</b>
E-mail	<a href="mailto:daina.andrejeva@lu.lv">daina.andrejeva@lu.lv</a>
<b>FACULTY OF MEDICINE</b>	
Departmental Coordinator	<b>Mr. Ivars PEKAINIS</b>
E-mail	<a href="mailto:ivars.pekainis@lu.lv">ivars.pekainis@lu.lv</a>
<b>FACULTY OF PHYSICS, MATHEMATICS AND OPTHOMETRY</b>	
Departmental Coordinator, Coordinator for Department of <b>Physics</b>	<b>Dr. Janis CIMURS</b>
E-mail	<a href="mailto:janis.cimurs@lu.lv">janis.cimurs@lu.lv</a>
Coordinator for Department of <b>Mathematics</b>	<b>Assoc. prof. Ingrida ULJANE</b>
E-mail	<a href="mailto:ingrida.uljane@lu.lv">ingrida.uljane@lu.lv</a>
Coordinator for Department of <b>Optometry</b>	<b>Aija TOLSTOJA</b>
E-mail	<a href="mailto:aija.tolstoja@lu.lv">aija.tolstoja@lu.lv</a>
<b>FACULTY OF SOCIAL SCIENCES</b>	
Departmental Coordinator:	<b>Ms. Aleksandra KJAKSTE</b>
E-mail	<a href="mailto:aleksandra.vonda@lu.lv">aleksandra.vonda@lu.lv</a>
<b>FACULTY OF THEOLOGY</b>	
Departmental Coordinator	<b>Doc. Janis RUDZITIS-NEIMANIS</b>
E-mail	<a href="mailto:janis.rudzitis@lu.lv">janis.rudzitis@lu.lv</a>